

Reversion	Engineering Change Description	Date	Owner
A/0	NEW	2021.07.07	ZXM

Electrical performance	
Characteristic impedance	50 Ω
Frequency range	DC to 8 GHz
Standing wave ratio (VSWR)	≤1.2 (DC~8GHz)
withstand voltage	≤0.1 x √f (GHz) dB
working voltage	335 V rms
Test voltage	1000 V rms
Insulation resistance	≥5000MΩ
Center pin contact resistance	≤3mΩ
Conductor contact resistance	≤2.5mΩ
Center conductor retention force	≥0.28N
Intermodulation 3rd order	N/A

Mechanical and environment	
Tempreture range	-40~+155℃
Salt spray test time	48H
Airtight	N/A
durability	≥500 cycles

Materials		
Connector parts	Material	Plating
Center contact	QBe	Au
Outer contact	brass	Au
Dielectric	PTFE	

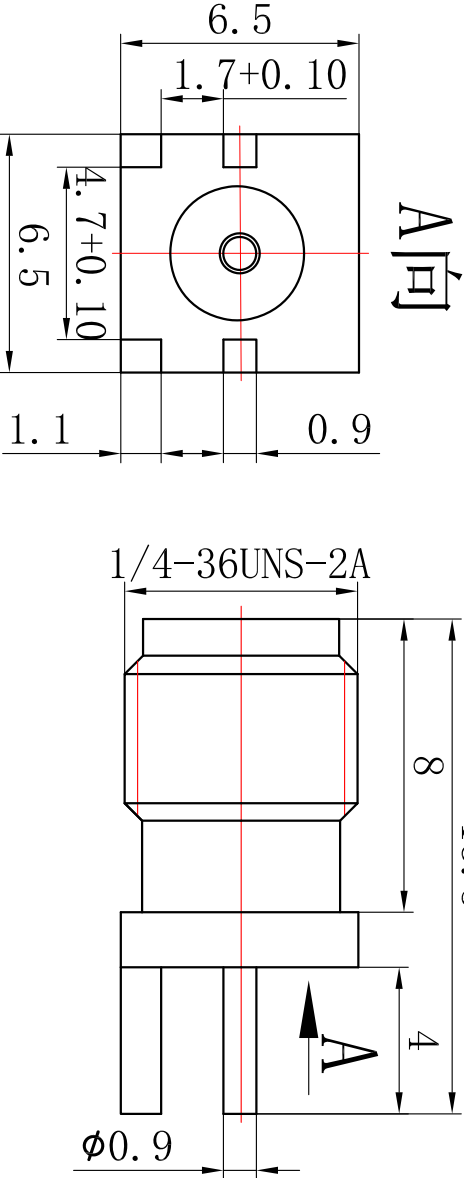

--	--	--	--	--	--	--	--	--	--

CAD GENERATED DRAWING, DO NOT MANUALLY UPDATE				STANDARD TOLERANCES (Unless stated otherwise)		Product design		<div>  <b>戴盛通信</b>  Dashing Com-Tek Co., Ltd </div>	
Any statements in this article shall not be interpreted as suggesting infringement of existing patents. Individual values may vary depending on factors including but not limited to application, design, cable type, assembly, and others workmanship				Geometric tolerances		Design			
				Positional tolerance		Drawn			
				ANGLE ±1°		Workmanship			
				Scale:		Checked			
				As mension		Approvals		Drawing No. : DS3.650.2436	
								TITLE: SMA-50KHD23	
								Company website: <a href="http://www.daisheng.net">http://www.daisheng.net</a> / Email: <a href="mailto:ds168@daisheng.net">ds168@daisheng.net</a>	