

Reversion	Engineering Change Description	Date	Owner
A/0	NEW	2018.01.12	ZXM

Electrical performance	
Characteristic impedance	50 Ω
Frequency range	DC to 4 GHz
Standing wave ratio(VSWR)	≤1.15 (DC~4G)
withstand voltage	≤0.1dB@3G
working voltage	500 V rms
Test voltage	1500 V rms
Insulation resistance	≥5000MΩ
Center pin contact resistance	≤1.5mΩ
Conductor contact resistance	≤1mΩ
Center conductor retention force	N/A
Intermodulation 3rd order	N/A

Mechanical and environment	
Tempreture range	-40~+155℃
Salt spray test time	96H
Airtight	N/A
durability	≥500 cycles

Materials		
Connector parts	Material	Plating
Center contact	bronze	Au
Outer contact	brass	Ni
Dielectric	PTFE	
Seal ring	Red silicone rubber	
Nut	brass	Ni
Gear washer	bronze	Ni

CAD GENERATED DRAWING,
DO NOT MANUALLY UPDATE

Any statements in this article shall not be interpreted as suggesting infringement of existing patents. Individual values may vary depending on factors including but not limited to application, design, cable type, assembly, and others workmanship

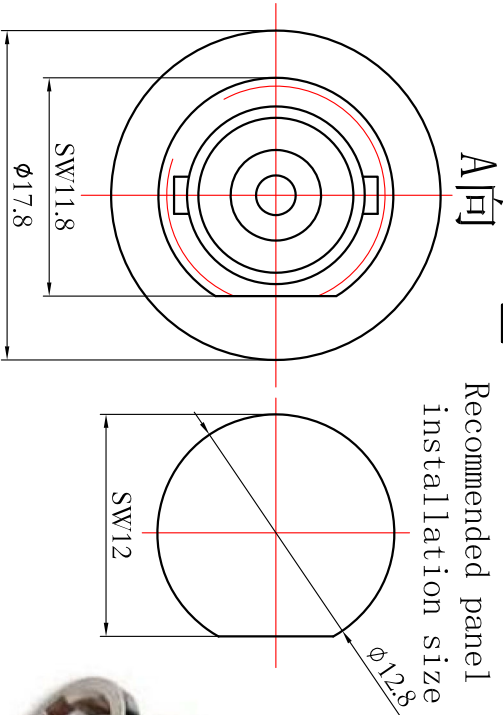
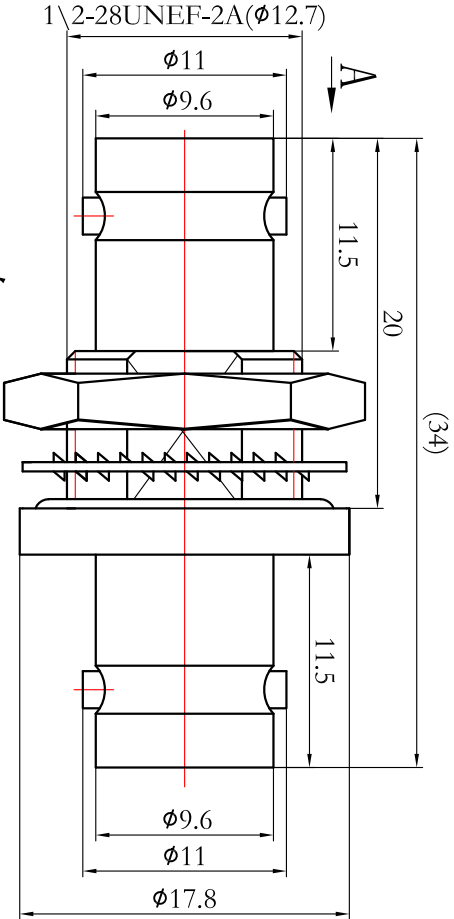

STANDARD TOLERANCES (Unless stated otherwise)				Product design	
Positional tolerance				Design	
Geometric tolerances				Drawn	
ANGLE ±1°				Workmanship	
Scale:				Checked	
As mension				Approvals	
Company website: http://www.daisheng.net / Email: ds168@daisheng.net					